

# Georgia Fire Service Training

*450+ Online Courses To Help Meet Training Requirements  
For Your 24 Georgia Firefighter Standards and Training Council  
Renewal Hours—With Automated Reporting To Acadis*

Vector Solutions offers an automated process of reporting training completions from our local LMS training management system, TargetSolutions, to the state's Acadis instance. There is no charge for AgencyConnect, the system which enables this real-time reporting automation.

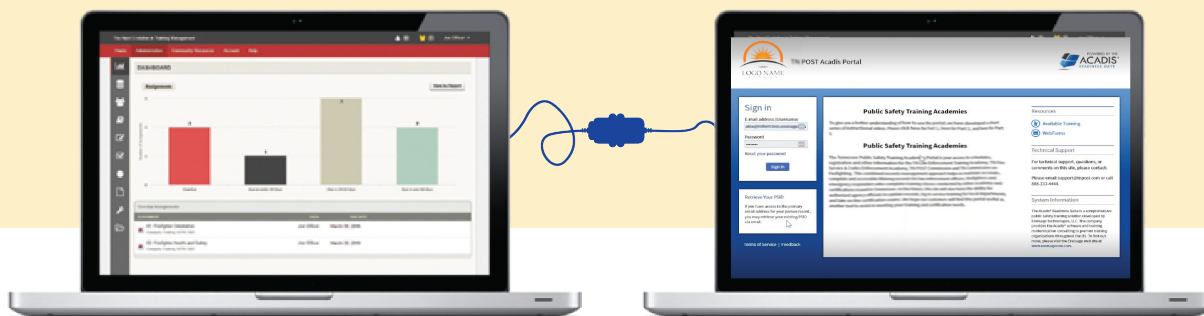

Vector Solutions has been working with the Georgia Firefighter Standards and Training Council (GFSTC) to simplify training renewal reporting for local departments in Georgia. Training completions from the TargetSolutions training management system can now be automatically sent to the GFSTC's Acadis instance to meet your 24 hours of annual continuing education for all of your fire certifications.

- No double data entry and no documentation uploads needed
- Vector offers high-quality online NFPA and fire courses to help meet the 24 hours GFSTC mandated training.
- Vector offers over 250 EMS courses to help your personnel meet 100% of their CEU requirements.
- All training (live skills, classroom, online), ISO tracking, EMS recertification CEUs, and reporting to GFSTC can be managed in one system.

With the TargetSolutions and Acadis integration, fire personnel in Georgia can now have a single source of truth for all their certifications and training records—from hire to retire—which not only reduces out-of-compliance risk, but also makes it easier to access records for compliance validation, pre-requisite documentation, reciprocity needs, and more.

**Training Officers LOVE TargetSolutions because all training (online, classroom, skills, etc.) is in one place—digital, searchable, reportable—and easy to track.**

## Vector's Fire Courses

Vector's Fire Courses	Hours
ARFF: Adapting and Using Structural Equipment	1
ARFF: Aircraft Cargo Hazards (2 modules)	1.5
ARFF: Aircraft Familiarization	0.5
ARFF: Aircraft Rescue - Emergency Communications	0.5
ARFF: Airport Rescue And Firefighting Ops	0.5
ARFF: Application of Extinguishing Agents (4 modules)	4
ARFF: Aviation Incident Response/Crash Rescue Management	1
ARFF: Command and Control of Aircraft Incidents	0.5
ARFF: Emergency Aircraft Evacuation	0.5
ARFF: Out of the Blue	0.5
ARFF: Personnel Safety	0.5
ARFF: Vehicle Rescue	1
ARFF: Water Rescue	1
Carbon Monoxide	1
Customer Service for Fire Department Personnel	1
Effective Fire Inspections at Places of Assembly	1
Electric and Alternative Fuel Vehicles for First Responders	1
Emergency Response to Terrorism (4 modules)	4
Ethics	1
Fire & EMS Grant Writing	1
Fire Alarm Systems	1
Fire Industry Driver Intersection Safety	1
Fire Industry Driver Operator	1
Fire Industry Introduction to Wildland Fire Behavior	1
Fire Service Health and Safety	1
Fire Service Health and Safety Part II	1
First Responder Hybrid Vehicle Incidents	1
Health and Wellness in Public Safety	1
High-Rise Safety Inspection	1
How to Read a Building	1
Human Trafficking Basics for First Responders	1
Interactions with Individuals with Disabilities	1

Vector's Fire Courses	Hours
Leadership and Ethics	1
Maximizing Your Volunteer Firefighter Recruitment Efforts with an Effective Open House	0.5
NFPA 1001 Building Construction	1
NFPA 1001 Fire Behavior	0.5
NFPA 1001 Fire Control	1
NFPA 1001 Fire Department Communications	1.5
NFPA 1001 Fire Detection, Alarm & Suppression Systems	1
NFPA 1001 Fire Hose	1
NFPA 1001 Fire Prevention and Public Education	1
NFPA 1001 Fire Streams	1
NFPA 1001 Firefighter Orientation and Safety	1
NFPA 1001 Firefighter Personal Protective Equipment	1
NFPA 1001 Firefighting Foams	1
NFPA 1001 Forcible Entry into a Structure	1
NFPA 1001 Ground Ladders	1
NFPA 1001 Loss Control	1
NFPA 1001 Portable Extinguishers	1
NFPA 1001 Protection of Evidence of Fire Origin & Cause	1
NFPA 1001 Rescue and Extrication	1
NFPA 1001 Self Contained Breathing Apparatus (SCBA)	1
NFPA 1001 Vehicle Extrication	1
NFPA 1001 Ventilation	1
NFPA 1001 Water Supply	1
NFPA 1021 Action Plan Implementation	1
NFPA 1021 Assuming the Role of Company Officer	1
NFPA 1021 Budgeting	1
NFPA 1021 Community Awareness	1
NFPA 1021 Company-Level Training	1
NFPA 1021 Elements of Supervision and Management	1
NFPA 1021 Fire and Life Safety Inspections	1
NFPA 1021 Fire Department Structure	1
NFPA 1021 Fire Investigation	1
NFPA 1021 Firefighter Safety and Health	1
NFPA 1021 Government Structure	1

Vector's Fire Courses	Hours
NFPA 1021 Incident Response Safety	1
NFPA 1021 Incident Scene Communications	1
NFPA 1021 Incident Scene Management	1
NFPA 1021 Information Management	1
NFPA 1021 Labor Relations	1
NFPA 1021 Leadership as a Group Influence	1
NFPA 1021 Legal Responsibilities and Liabilities	1
NFPA 1021 Pre-Incident Planning	1
NFPA 1021 Professional Ethics	1
NFPA 1021 Public Education Programs	1
NFPA 1041: Fire Service Instructor I	1
NFPA 1041: Fire Service Instructor II	2
NFPA 1041: Fire Service Instructor III	1
NFPA 1403 Live Fire Training Evolutions	1
NFPA 1410 Evolution 01 - Forward hose lay	1
NFPA 1410 Evolution 02 - Deferring water supply to the second due and request that engine two reverse lay in	1
NFPA 1410 Evolution 03 - Two-engine forward lay	1
NFPA 1410 Evolution 04 - Reverse lay and bring the water supply by ways of LDH closer to the fire scene	1
NFPA 1410 Evolution 05 - Two engines, one supply line, and two handlines to complete a drafting operation	1
NFPA 1410 Evolution 06 - Achieve permanent water supply through a water shuttle evolution	1
NFPA 1410 Evolution 07 - Reverse lay with a portable ground monitor	1
NFPA 1410 Evolution 08 - Complete a forward lay and achieve 500 gpm flow for the master stream	1
NFPA 1410 Evolution 09 - Aerial apparatus and elevated master stream	1
NFPA 1410 Evolution 10 - Reverse lay from an apparatus equipped with an elevated master stream	1
NFPA 1410 Evolution 11 - Four supply lines and two engines; one equipped with an elevated master stream device	1
NFPA 1410 Evolution 12 - Forward lay with an engine and sprinkler connections with two supply lines	1

Vector's Fire Courses	Hours
NFPA 1410 Evolution 13 - Reverse lay with with two supply lines and sprinkler connections	1
NFPA 1410 Evolution 14 - Forward lay from the engine with a single large diameter hose and two supply lines	1
NFPA 1500 Bloodborne Pathogens Safety	1
NFPA 1500 Combustible & Flammable Liquids	1
NFPA 1500 Compressed Gas Safety	1
NFPA 1500 Confined Space Entry	1
NFPA 1500 CPR Academic	1
NFPA 1500 Driving Safety	1
NFPA 1500 Hazard Communication	1
NFPA 1500 Hazardous Material Identification and Spill Prevention	1
NFPA 1500 Laboratory Safety	1
NFPA 1500 Materials Handling, Storage, Use & Disposal	1
NFPA 1500 Personal Protective Equipment	1
NFPA 1500 Respiratory Protection	1
NFPA 1500 Welding Safety	1
NFPA 1500: Post-Traumatic Stress Disorder (PTSD) in the Fire Industry	2
NFPA 1584 Firefighter Rehabilitation (2 modules)	4
NFPA 1851 - Cancer Related Risks of Firefighting	2
NFPA 3000: Standard for Preparedness and Response to Active Shooter and/or Hostile Events	1.5
NFPA 470: Advanced HAZWOPER Awareness (4 modules)	8
NFPA 470: HAZMAT Operations Level Refresher (4 modules)	8
NFPA 470: HAZMAT Transportation	1
Rope, Rope Rescue, Knots	1
RT-130: Annual Wildland Fire Safety Refresher (4 modules)	8
S-190 Introduction to Wildland Fire Behavior (4 modules)	8
School Fire and Life Safety Inspection	1
Understanding Autism Spectrum Disorder for First Responders	1
Understanding Discrimination and Harassment in Fire and EMS	1

## Vector's EMS Courses

Vector's EMS Courses	Hours	Accreditation
Abdominal Trauma	1	CAPCE
Acute Coronary Syndromes	1	CAPCE
Acute Respiratory Distress Syndrome	1	CAPCE
Advanced Airways: Intubation and Beyond	2	CAPCE
Advanced Allergic Reaction Management	1	CAPCE
Advanced Cervical Spinal Injuries: Special Considerations for Athletics	1	CAPCE
Altitude Emergencies	1	CAPCE
Amputation Injuries	1	CAPCE
Aquatic Emergencies	1	CAPCE
Assessing the Patient with Major Trauma	2	CAPCE
Assessment and Treatment of Altered Mental Status	1	CAPCE
Assessment and Treatment of Foot Injuries	1	CAPCE
Assessment and Treatment of Sexual Assault Patients	1	CAPCE
Assessment and Treatment of Submersion Injuries	1	CAPCE
Assessment, Treatment and Transport of Morbidly Obese Patients	1	CAPCE
Asthma Advanced	1	CAPCE
Asthma Advanced Clinical Concepts	1	CAPCE
Back Injury Prevention	1	CAPCE
Bariatric Patients	1	CAPCE
Basic Airway Skills and Adjuncts	1	CAPCE
Basic Allergic Reaction Management	1	CAPCE
Basics of Arrhythmias: Tachyarrhythmias and Fibrillation	1	CAPCE
Basics of Cardiac Arrhythmias and Premature Complex Rhythms	1	CAPCE
Behavioral Emergencies	1	CAPCE
Bleeding and Shock	1	CAPCE
Bloodborne Pathogens Safety	1	CAPCE
Burn Management	1	CAPCE
Capnography	1	CAPCE
Carbon Monoxide Poisoning	1	CAPCE
Cardiac Emergencies	1	CAPCE
Cardiovascular Anatomy & Physiology	1	CAPCE
Central Nervous System (CNS) Injuries	1	CAPCE
Child Abuse: An EMS Professionals Role & Responsibilities	1	CAPCE
Clinical Decision-Making	1	CAPCE
Common Infectious Pathogens	1	CAPCE
Communication and Documentation	1	CAPCE
Complementary and Alternative Medicine	1	CAPCE
Confined Space Awareness	1	CAPCE
Controlled Substance Compliance	0.5	
CPR Academic	1	CAPCE
Crime Scene Awareness	1	CAPCE
Death and Dying	1	CAPCE
Dementia: Overview, Assessment, and Care	1	CAPCE
Detailed Physical Exam	1	CAPCE

Vector's EMS Courses	Hours	Accreditation
Diet & Nutrition	1	CAPCE
Driving Safety	1	CAPCE
Emergency Care for Electrical Burns	1	CAPCE
Emergency Responder Rehabilitation	1	CAPCE
Emergency Response to Terrorism (4 modules)	4	CAPCE
Endocrine System Emergencies	1	CAPCE
Environmental Emergencies	1	CAPCE
Epilepsy	1	CAPCE
Ethics for EMS Providers	1	CAPCE
Femur Fractures	1	CAPCE
Functional Approach to Physical Fitness	1	CAPCE
Functional Communication for EMS Providers	2	CAPCE
Fundamentals of 12 Lead ECG Operation and Interpretation	1	CAPCE
Geriatric Assessment Challenges	1	CAPCE
Geriatric Behavioral Emergencies	2	CAPCE
Geriatric Emergencies	1	CAPCE
Grey Area Calls	1	CAPCE
Gunshot Wounds and Bomb Blast Injuries	2	CAPCE
Hazard Communication	1	CAPCE
HazMat Medical Emergencies	1	CAPCE
Health and Wellness	1	CAPCE
Health and Wellness in Public Safety	1	CAPCE
Heat Illness and Emergencies	1	CAPCE
Hematology	1	CAPCE
Hip and Pelvic Injuries	1	CAPCE
HIPAA Awareness	1	CAPCE
HIV/AIDS Awareness	2	CAPCE
Human Trafficking Basics for First Responders	1	CAPCE
Hypothermia Assessment and Treatment	1	CAPCE
Immunology	1	CAPCE
Incident Command System (ICS): with Applications for EMS	1	CAPCE
Infectious Disease Control	1	CAPCE
Injuries and Infections of the Eye	1	CAPCE
Interactions with Individuals with Disabilities	1	CAPCE
Intraosseous Infusion	1	CAPCE
Introduction to Hazardous Materials	1	CAPCE
Kinematics of Trauma	1	CAPCE
Managing Cardiac Arrest: During and After Resuscitation	2	CAPCE
Managing Chronic Care Patients	1	CAPCE
Managing Multiple Casualty Incidents	1	CAPCE
Mechanics of Breathing	1	CAPCE
Medical Extrication and Rescue	1	CAPCE
Medical, Ethical, and Legal Issues	1	CAPCE
Medication Errors	1	CAPCE

Vector's EMS Courses	Hours	Accreditation
Mental Health for Emergency Responders	1	CAPCE
Methamphetamine	1	CAPCE
MRSA Infections	1	CAPCE
Musculoskeletal Injuries	1	CAPCE
Myths and Realities of Drug-Seeking Behavior	1	CAPCE
Narcotics Overdose	1	CAPCE
Neonatology	2	CAPCE
Non-Traumatic Abdominal Injuries	1	CAPCE
Non-Traumatic Chest Pain	1	CAPCE
Obstetrical Emergencies	1	CAPCE
Operating an AED	1	CAPCE
Opioid Overdose & Naloxone Administration	1	CAPCE
Pain Management	1	CAPCE
Pain Transmission, Perception, and Assessment	1	CAPCE
Patient Abuse and Assault	1	CAPCE
Patient Assessment	1	CAPCE
Patient Care Report Essentials	1	CAPCE
Patient Lifting, Moving and Transportation	1	CAPCE
Patient Refusal	1	CAPCE
Patient Restraint for EMS Providers	1	CAPCE
Patients with Special Challenges	1	CAPCE
Pediatric Airway Management	1	CAPCE
Pediatric Assessment	1	CAPCE
Pediatric Burns (Advanced)	1	CAPCE
Pediatric Cardiac Arrest	1	CAPCE
Pediatric Emergencies (2 modules)	2	CAPCE
Pediatric Fever	1	CAPCE
Pediatric Ingestions	1	CAPCE
Pediatric Respiratory Emergencies: Upper and Lower Airway for the First Responder	1	CAPCE
Pediatric Seizures	1	CAPCE
Pediatric Shock	1	CAPCE
Pediatric Trauma	2	CAPCE
Pharmacology	2	CAPCE
Pharmacology (Advanced)	2	CAPCE
Pharmacology & Drug Administration	1	CAPCE
Poisoning and Overdose	1	CAPCE
Prehospital Considerations for Diversity, Equity and Inclusion in EMS	1	CAPCE
Prehospital Pulmonary Embolism Care	1	CAPCE
Protecting Yourself from Influenza	1	CAPCE
Rapid Secondary Assessment	1	CAPCE
Respiratory Emergencies Basic	1	CAPCE
Respiratory System A&P Review	1	CAPCE
Response for COVID-19 (PPE, Decon, and Transport)	0.5	
Sepsis	1	CAPCE



Vector's EMS Courses	Hours	Accreditation
Shock and Shock Management	1	CAPCE
Slips, Trips and Falls	1	CAPCE
Special Challenges in Patient Assessment	1	CAPCE
Special Needs Patients	1	CAPCE
Spinal Cord Injuries	2	CAPCE
Stroke Assessment & Treatment	1	CAPCE
Supplemental Oxygen	1	CAPCE
The Human Body Part 1 - Critical Systems	1	CAPCE
The Human Body Part 2 - Other Systems	1	CAPCE
Thoracic Emergencies	1	CAPCE
Toxicology and Substance Abuse	1	CAPCE
Tracheostomies	2	CAPCE
Trauma Assessment for Head and Neck Injuries	1	CAPCE
Traumatic Brain Injuries	1	CAPCE
Tricyclic Antidepressant (TCA) Overdose	1	CAPCE
Understanding Autism Spectrum Disorder for First Responders	1	CAPCE
Understanding Discrimination and Harassment in Fire and EMS	1	CAPCE
Understanding the Basics of ECGs	1	CAPCE
Weapons of Mass Destruction	1	CAPCE
Workplace Stress	1	CAPCE

**Vector Solutions also offers courses in driver assessment and training, OSHA, cybersecurity, IT, business skills, and more.**

Courses are subject to change as Vector Solutions updates our courses and state legislation changes mandated training requirements. Please check with your certification authorities in your state to confirm these courses meet your state's requirements.

V\_08082024

